

FEATURES

- 3 BEDROOMS WITH 2.5 BATHROOMS
- SIDE LOAD 2 CAR GARAGE WITH WORKSHOP
- SEPARATE LIVING AND FAMILY ROOM
- LARGE KITCHEN WITH WALK-IN PANTRY
- LARGE MASTER SUITE WITH ADJACENT DEN
- LARGE REAR PORCH OVERLOOKING POOL
- BRICK AND SIDING EXTERIOR

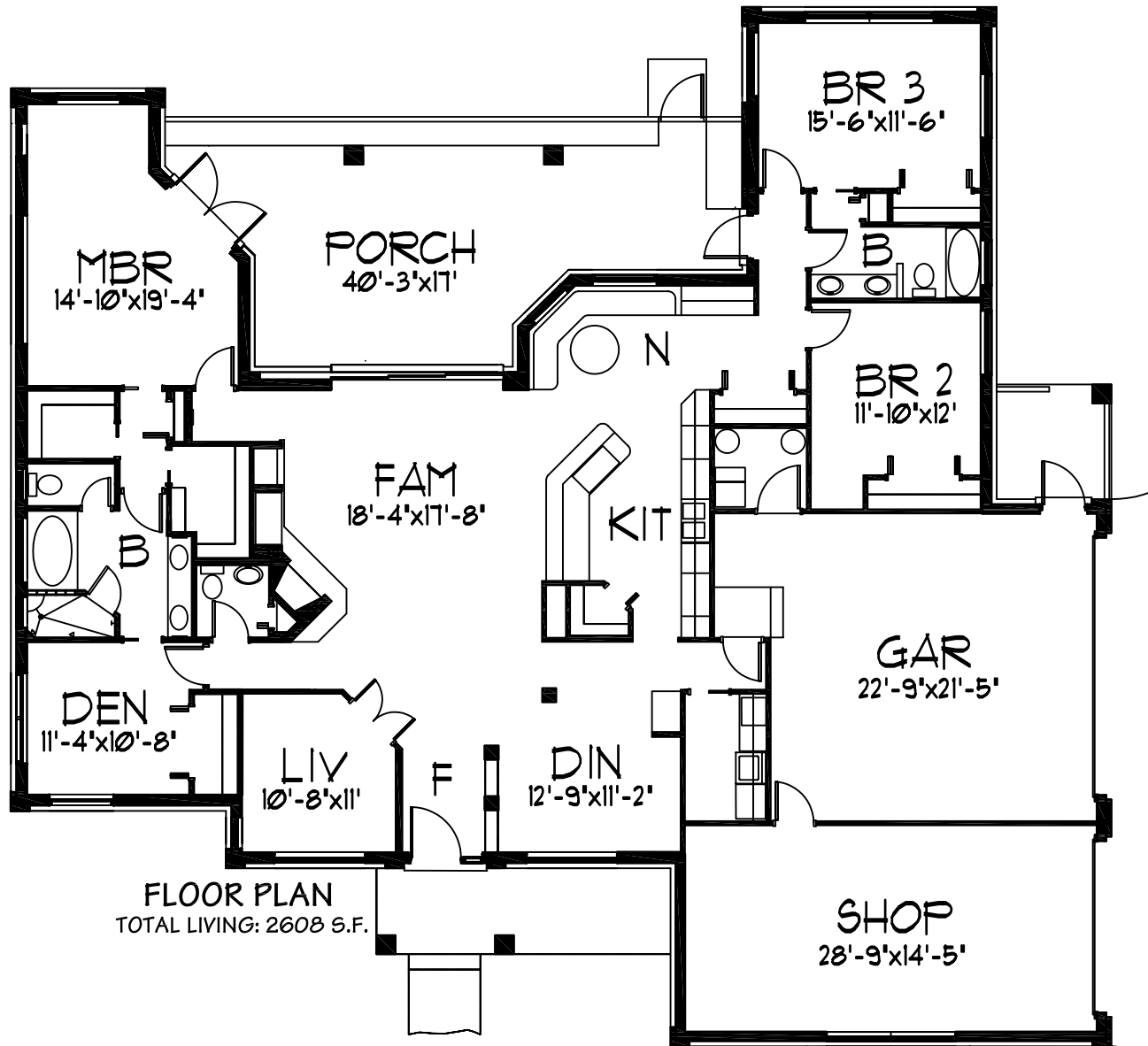

FLOOR PLAN
TOTAL LIVING: 2608 S.F.



FRONT ELEVATION

© 2000 A BETTER PLAN, INC.

A BETTER PLAN, INC.
2090 W. EAU GALIE BLVD., SUITE. B
MELBOURNE, FL. 32955

2608-1
PLYMOUTH